

Locking Devices

10 Amp and 15 Amp Non-NEMA Locking Devices

10A 250V and 15A 125V Locking Devices,
3-Pole 3-Wire Non-Grounding and 2-Pole 3-Wire Grounding Inches (mm)



Rating	Poles/ Wires	Cord Diameter	Description	Triple Gripper		Flanged Devices Equipment Base with Binding Screw Terminals		Receptacle, Back and Side Wired	
				Nylon Plug	Nylon Connector	Male White Nylon	Female White Nylon	Single All Black Nylon	Duplex All Black RTP
10A 250V, Non-Grounding	3-Pole 3-Wire	.300"-.655" (7.6-16.6)	Black/White	7568NP	7565NC	7556MB	7557ER	7582	7580DR
	Plug Connector		Corrosion- Resistant Yellow/White	7568NPCR	7565NCCR	—	—	—	—
15A 125V, Grounding	2-Pole 3-Wire		All Black	—	—	—	—	7582G	7580GDR

Note: Wiring devices on this page are **no longer listed by Underwriters Laboratories Inc.**, and are intended for **replacement use only** in existing installations. We recommend that they not be used in new installations. These devices formerly complied with UL Standards, however, due to revisions of these Standards, the devices can no longer be listed. For new installations, refer to the NEMA configuration chart on page G-2 for the products suited for your particular current and voltage requirements. **CAUTION:** To Avoid Electric Shock-Review premises carefully and do not use if slot or blade configuration (design) is already in a circuit having a rating differing from the rating of this device. See page G-20 for weather protective boots for 10 and 15 amp nylon locking plugs.

Product Dimensions Inches (mm)

	Plug	
	10A	20A
A	2.18" (55.4)	2.60" (66.0)
B	1.38" (35.1)	1.80" (45.7)
C	1.53" (38.9)	2.11" (53.6)

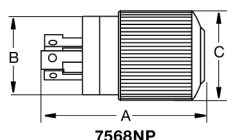

7568NP

	Connector	
	10A	20A
A	2.95 (75.0)	3.73 (94.7)
B	1.38" (35.1)	1.80 (45.7)
C	1.53" (38.9)	2.11 (53.6)

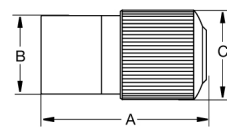

7565NC

	Flanged Devices	
	10A	20A
A	2.38" (60.5)	2.87" (73.9)
B	2.19" (55.5)	2.20"
C	2.00" (50.8)	2.50" (63.5)
D	1.84" (46.7)	1.27" (32.3)
E	1.68" (42.6)	2.01" (51.1)
F	1.58" (40.1)	(3) 0.19" (4.8)

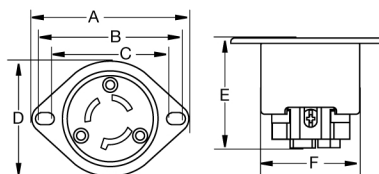

10A - 7556MB and 7557ER

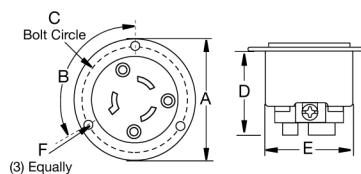

20A - 7327 and 7328

	Duplex Receptacles	Single Receptacles	
	10A	10A	20A
A	3.28" (83.3)	3.28" (83.3)	3.28" (83.3)
B	2.38" (60.5)	2.38" (60.5)	2.38" (60.5)
C	1.38" (35.1)	1.38" (35.1)	1.38" (35.1)
D	1.41" (35.8)	1.41" (35.8)	1.39" (35.3)
E	1.37" (34.8)	1.37" (34.8)	2.20" (55.9)
F	1.01" (25.7)	1.01" (25.7)	0.86" (21.8)

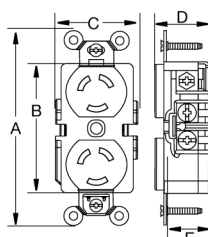

10A - 7550DR

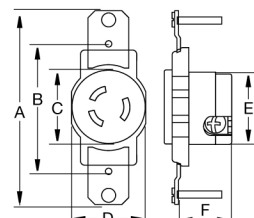

10A - 7582

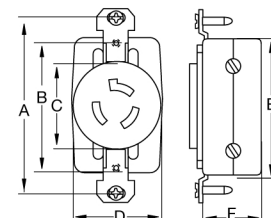

20A - 7310

Locking Devices



20 Amp Non-NEMA Locking Devices

20A 125/250V, 250V AC and 3ØY 120/208V AC Locking Devices,
Grounding and Non-Grounding Inches (mm)



Rating	Poles/ Wires	Cord Diameter	Description	Nylon Construction		Flanged Devices Equipment Base with Binding Screw Terminals		Single Receptacle Back and Side Wired
				Plug	Connector	Male White Nylon	Female White Nylon	All Black Urea
20A 125/250V AC, Non-Grounding Plug Connector	3-Pole 3-Wire	.375"-1.000" (9.5-25.4)	Black/White	9965	7314	7327	7328	—
			All Black	9965NB	7314NB	—	—	7310
			Sentinel Yellow	9965NSY	7314NSY	—	—	—
20A 250V AC, Grounding Plug Connector	2-Pole 3-Wire		All Black	—	—	—	—	7310G*
20A 3ØY 120/208V, Non-Grounding Plug Connector	4-Pole 4-Wire	.625"-1.150" (15.9-29.2)	Black/White	9967	7414	7408MB	7409ER	7410
			All Black	9967NSY	7414NSY	—	—	7410**
20A 250V AC, Grounding Plug Connector	3-Pole 4-Wire		All Black	—	—	—	—	7410G*
20A 3ØY 120/208V AC, Grounding Plug Connector	4-Pole 5-Wire	.625"-1.150" (15.9-29.2)	Black/White	3521	3523	—	—	—

Note: Rating Change: All devices listed on this page are intended for replacement use only in existing installations. We recommend that they not be used in new installations. Both standard and suffix "G" devices were formerly dual rated 20 Amp 250V AC or DC, 10 Amp 600V AC. Suffix "G" devices are intended for equipment grounding applications and formerly complied with UL Standards. However, due to revisions of these Standards, suffix "G" devices are no longer UL Listed and the rating of non-grounding devices has been changed to 20 Amp 125/250V. For new installations, refer to the NEMA configuration chart on G-2 for the products suited for your particular current and voltage requirements. **CAUTION:** To Avoid Electric Shock-Review premises carefully and do not use if slot or blade configuration (design) is already in a circuit having a rating differing from the rating of this device. See page G-20 for weather protective boots for 20 amp nylon locking plugs.

*Not UL Listed. For Replacement use only.

**Catalog number 7410 on 4 in. (101.6) round metal box cover. Not CSA Certified.

Product Dimensions Inches (mm)

Plug	
A	2.60" (66.0)
B	1.80" (45.7)
C	2.11" (53.6)
Connector	
A	3.73" (94.7)
B	1.80" (45.7)
C	2.11" (53.6)

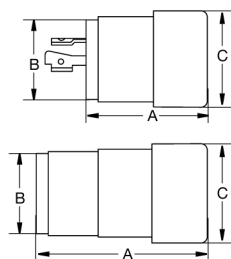

	Single Receptacle	Flanged Devices
A	3.28" (83.3)	3.06" (77.7)
B	2.38" (60.5)	120°
C	1.56" (39.6)	2.68" (68.1)
D	1.71" (43.4)	2.27" (57.7)
E	2.50" (63.5)	2.23" (56.6)
F	1.14" (29.0)	(3) 0.19" (4.8)

